



GB BUILT-IN STOP TAP

Art.5960 12 - 5970 12
Art.5960 34 - 5970 34

BUILT-IN STOP TAP 1/2"-3/4"
WITH 1/2"-3/4" CONNECTION

Art.5961 12 - 5971 12
Art.5961 34 - 5971 34

BUILT-IN STOP TAP 1/2"-3/4"
WITH PRESSFAR FITTING

Art.5962 12 - 5972 12
Art.5962 34 - 5972 34

BUILT-IN STOP TAP 1/2"-3/4" WITH
ELBOW PRESSFAR FITTING

Art.5963 12 - 5973 12
Art.5963 34 - 5973 34

BUILT-IN STOP TAP 1/2"-3/4" WITH
HANDLE AND PRESSFAR FITTING

Art.5964 12 - 5974 12
Art.5964 34 - 5974 34

BUILT-IN STOP TAP 1/2"-3/4"
WITH HANDLE

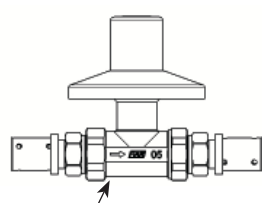
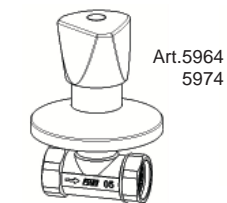
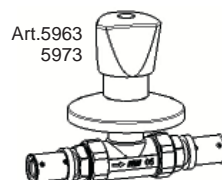
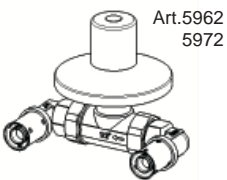
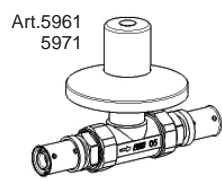
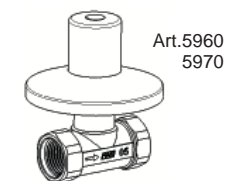
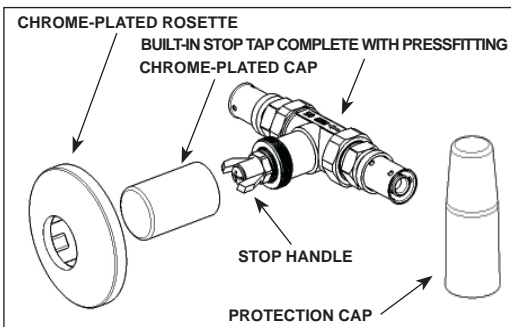

INSTALL THE BUILT-IN STOP TAP FOLLOWING
THE ARROW DIRECTION

Nominal pressure: 10bar
Max temperature: 95°C
Usable fluids: water



GB Art.5981: EXTENTION FOR BUILT-IN STOP TAP

1 REMOVE THE PLASTIC/BRASS PARTS FROM THE BUILT-IN STOP TAP

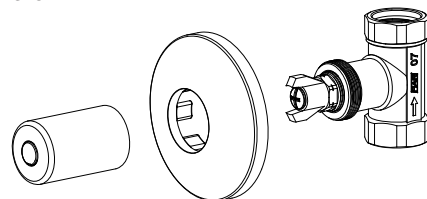

2 UNSCREW THE SCREW AND TAKE OFF THE PLASTIC HANDLE TAP

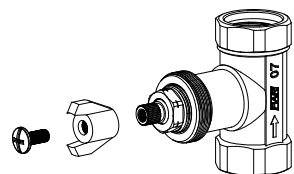

3 TAKE THE 20mm EXTENTION (ART.5981)

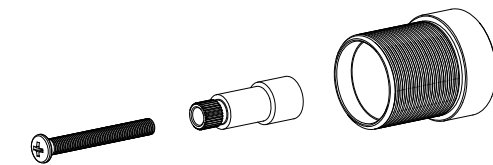

4 ASSEMBLE THE WHOLE AS SHOWN IN THE PICTURE

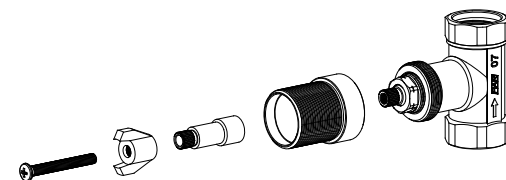

5 REASSEMBLE THE PLASTIC/BRASS PARTS ON THE BUILT-IN STOP TAP

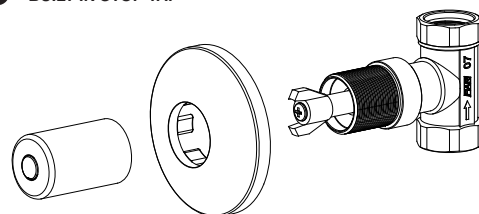

I RUBINETTO AD INCASSO

Art.5960 12 - 5970 12
Art.5960 34 - 5970 34

RUBINETTO AD INCASSO 1/2"-3/4"
ATTACCHI 1/2"-3/4"

Art.5961 12 - 5971 12
Art.5961 34 - 5971 34

RUBINETTO AD INCASSO 1/2"-3/4"
CON PRESSFAR

Art.5962 12 - 5972 12
Art.5962 34 - 5972 34

RUBINETTO AD INCASSO 1/2"-3/4"
CON GOMITI PRESSFAR

Art.5963 12 - 5973 12
Art.5963 34 - 5973 34

RUBINETTO AD INCASSO 1/2"-3/4"
CON MANIGLIA E PRESSFAR

Art.5964 12 - 5974 12
Art.5964 34 - 5974 34

RUBINETTO AD INCASSO 1/2"-3/4"
ATTACCHI 1/2"-3/4" CON MANIGLIA

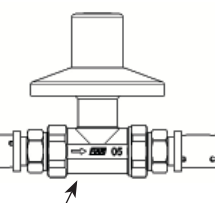
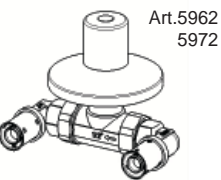
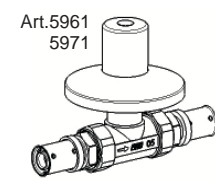
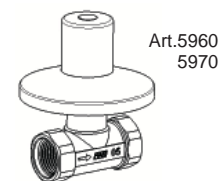
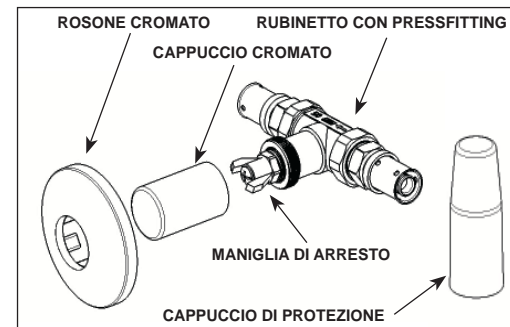

INSTALLARE IL RUBINETTO RISPETTANDO LA FRECCIA
DIREZIONALE

Pressione nominale: 10bar
Temperatura massima: 95°C
Fluidi utilizzabili: acqua



I Art.5981: PROLUNGA PER RUBINETTO AD INCASSO

1 RIMUOVERE I COMPONENTI IN PLASTICA/OTTONE DAL RUBINETTO AD INCASSO

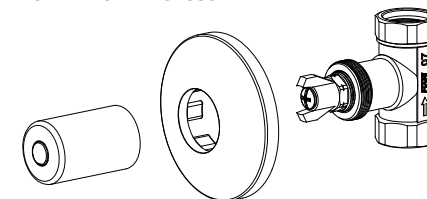

2 SVITARE LA VITE E TOGLIERE LA MANIGLIA IN PLASTICA

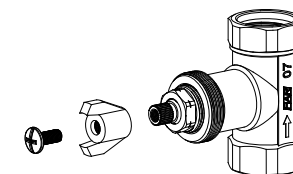

3 PRENDERE LA PROLUNGA 20mm COMPLETA (ART.5981)

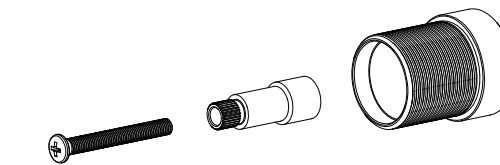

4 ASSEMBLARE COME RAPPRESENTATO NEL DISEGNO

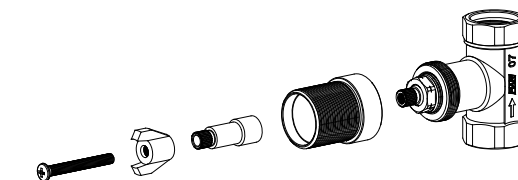

5 RIMONTARE I COMPONENTI IN PLASTICA/OTTONE DEL RUBINETTO AD INCASSO

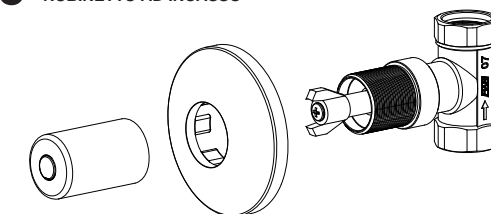



LLAVE DE EMPOTRAR

- Art.5960 12 - 5970 12 LLAVE DE EMPOTRAR 1/2"-3/4"
- Art.5960 34 - 5970 34
- Art.5961 12 - 5971 12 LLAVE DE EMPOTRAR 1/2"-3/4"
- Art.5961 34 - 5971 34 Y PRESSFAR
- Art.5962 12 - 5972 12 LLAVE DE EMPOTRAR 1/2"-3/4"
- Art.5962 34 - 5972 34 Y RACOR CODO PRESSFAR
- Art.5963 12 - 5973 12 LLAVE DE EMPOTRAR 1/2"-3/4"
- Art.5963 34 - 5973 34 CON PRESSFAR Y MANETA
- Art.5964 12 - 5974 12 LLAVE DE EMPOTRAR 1/2"-3/4"
- Art.5964 34 - 5974 34 Y MANETA

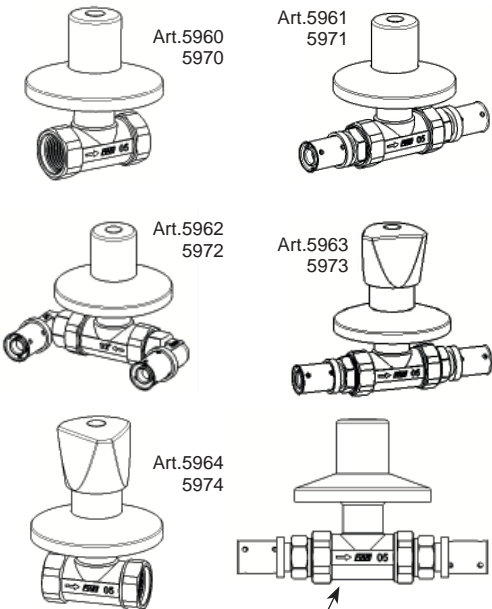
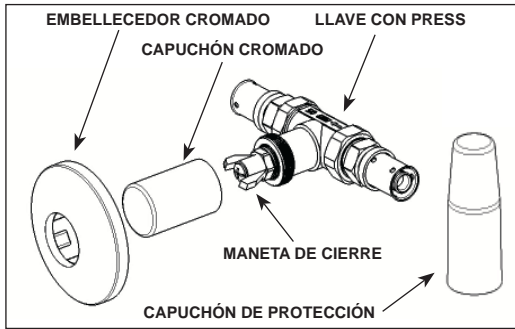

INSTALAR LA LLAVE RESPETANDO LA DIRECCIÓN DE LA FLECHA

Presión nominal: 10bar
Temperatura máxima: 95°C
Fluido utilizable: Agua



Art.5981: PROLONGACION PARA LLAVE DE EMPOTRAR

1 SACAR EL COMPONENTE DE PLÁSTICO/LATON DE LLAVE DE EMPOTRAR

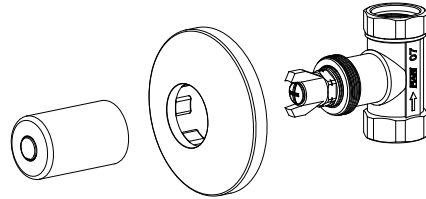

2 DESENROSCAR EL TORNILLO Y SACAR LA MANETA DE PLÁSTICO

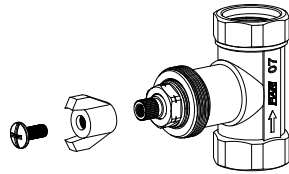

3 TOMAR LA PROLONGACIÓN DE 20mm COMPLETA (ART.5981)

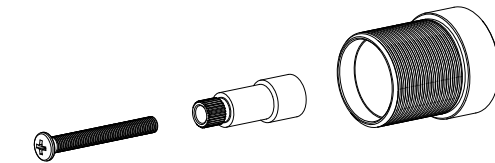

4 ENSAMBLARLA COMO SE REPRESENTA EN EL DISEÑO

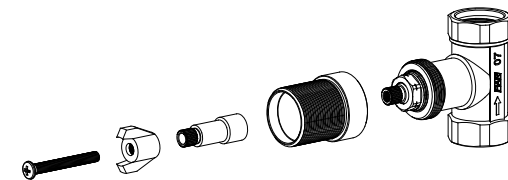

5 COLOCAR EL COMPONENTE DE PLÁSTICO/LATON DE LA LLAVE DE EMPOTRAR

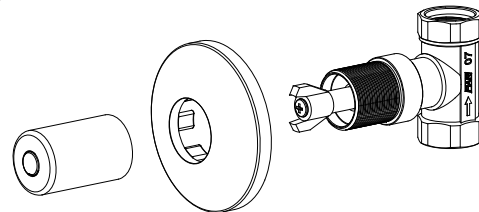

Вентиль под штукатурку

- Apt.5960 12 - 5970 12 Вентиль с колпаком под штукатурку
- Apt.5960 34 - 5970 34
- Apt.5961 12 - 5971 12 Вентиль с колпаком под штукатурку,
- Apt.5961 34 - 5971 34 с пресс-фитингами
- Apt.5962 12 - 5972 12 Вентиль с колпаком под штукатурку,
- Apt.5962 34 - 5972 34 с пресс-угольниками
- Apt.5963 12 - 5973 12 Вентиль с ручкой под штукатурку,
- Apt.5963 34 - 5973 34 с пресс-фитингами
- Apt.5964 12 - 5974 12 Вентиль с ручкой под штукатурку
- Apt.5964 34 - 5974 34

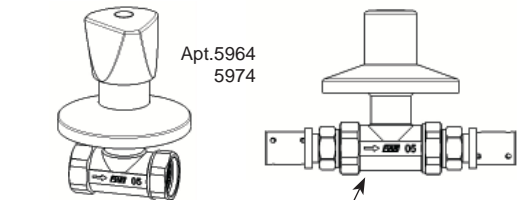
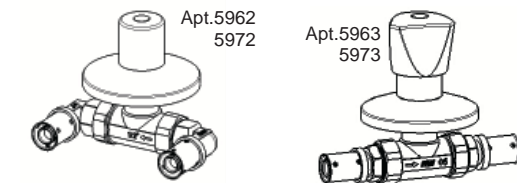
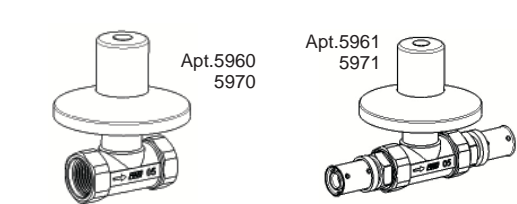
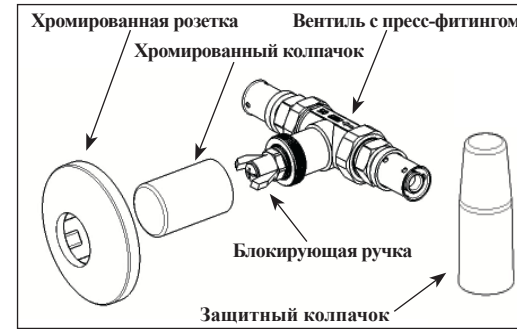

Установить вентиль согласно стрелке на корпусе вентиль.
Номинальное давление: 10 бар
Максимальная температура: 95°C
Теплоноситель: вода



Art.5981-Удлинитель для вентиль под штукатурку

1 Снять с вентиль пластиковые детали

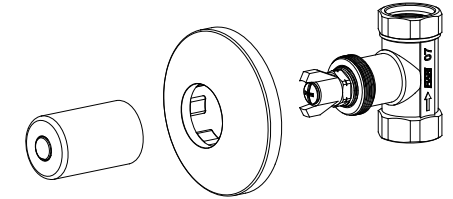

2 Открутить болт и снять пластиковую ручку

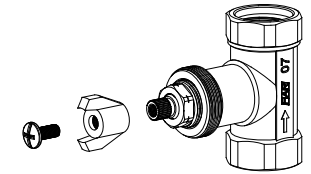

3 Взять удлинитель на 20mm (арт.5981)

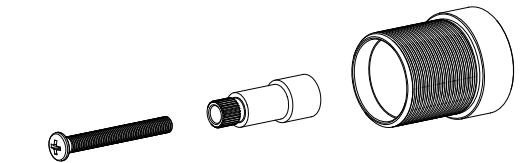

4 Собрать как показано на рисунке.

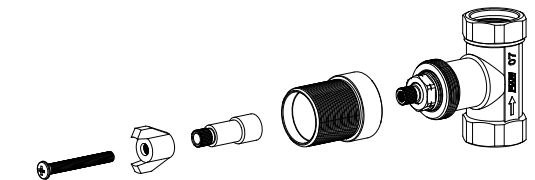

5 Соединить пластиковые детали

